

festbestückte Profilfräser

02_2012

**alle
Preise auf
Anfrage**

2012

conax UG · Ehrensteinstr. 16 · 04105 Leipzig · Tel. 0341/5628820 · Fax 0341/5628823

www.conax.de · info@conax.de

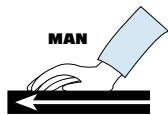

HW
HSS

ART. 1

FRESA SAGOMATA

PROFILED CUTTER ON REQUEST
FRAISE PROFILÉE SUR DEMANDE
PROFIL FRAESER
FRESA PERFILADA

P = max 10 mm

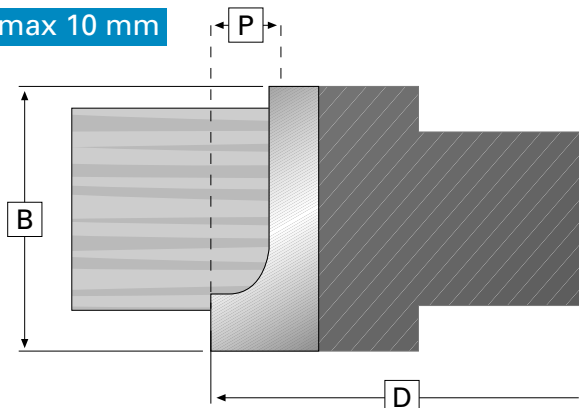

Costruita su disegno o campione legno. Con taglianti riportati in HSS o HW con sagoma profilo P=max 10mm
Cutter on request HSS or HW tipped with profile depth P=max 10mm
Fraise profilée sur demande brasée en HSS ou HW avec avancement P= max 10mm
Fräseser nach Zeichnung oder Holzmuster mit Aufbauschneiden aus HSS oder HW und Profil P=max 10 mm
Fresa construida a diseño o según muestra de madera soldada en HSS ou HW a perfil P=max 10mm

D.100 n. 7700 - 12000
D.120 n. 6400 - 9500
D.140 n. 5500 - 8000
D.160 n. 4800 - 7000
D.180 n. 4300 - 6300
D.200 n. 3900 - 5700

Z=4

Art.	D	B	Cod*	Art.	D	B	Cod*
001.100.Z410	100	10	42G	001.120.Z410	120	10	43D
001.100.Z420	100	20	43D	001.120.Z420	120	20	44E
001.100.Z430	100	30	44D	001.120.Z430	120	30	45E
001.100.Z440	100	40	45G	001.120.Z440	120	40	46J
001.100.Z450	100	50	47D	001.120.Z450	120	50	48E
001.100.Z460	100	60	48C	001.120.Z460	120	60	49F
001.100.Z470	100	70	49C	001.120.Z470	120	70	50G
001.100.Z480	100	80	50G	001.120.Z480	120	80	52A
001.100.Z490	100	90	51J	001.120.Z490	120	90	53F
001.100.4100	100	100	53C	001.120.4100	120	100	54J
001.140.Z410	140	10	44A	001.160.Z410	160	10	44I
001.140.Z420	140	20	45B	001.160.Z420	160	20	45J
001.140.Z430	140	30	46C	001.160.Z430	160	30	47D
001.140.Z440	140	40	47H	001.160.Z440	160	40	49B
001.140.Z450	140	50	49B	001.160.Z450	160	50	50C
001.140.Z460	140	60	50C	001.160.Z460	160	60	51C
001.140.Z470	140	70	51D	001.160.Z470	160	70	52E
001.140.Z480	140	80	52H	001.160.Z480	160	80	53F
001.140.Z490	140	90	54C	001.160.Z490	160	90	55C
001.140.4100	140	100	55G	001.160.4100	160	100	60E
001.180.Z410	180	10	45E	001.200.Z410	200	10	46D
001.180.Z420	180	20	46J	001.200.Z420	200	20	47G
001.180.Z430	180	30	48E	001.200.Z430	200	30	49B
001.180.Z440	180	40	49I	001.200.Z440	200	40	50G
001.180.Z450	180	50	51D	001.200.Z450	200	50	52A
001.180.Z460	180	60	52E	001.200.Z460	200	60	53A
001.180.Z470	180	70	53F	001.200.Z470	200	70	54C
001.180.Z480	180	80	54J	001.200.Z480	200	80	55F
001.180.Z490	180	90	60C	001.200.Z490	200	90	60E
001.180.4100	180	100	60J	001.200.4100	200	100	61D

- PER FRESE CON AVANZAMENTO MECCANICO (MEC) O MANUALE (MAN) STESSO PREZZO
- FOR CUTTERS WITH MECHANICAL FEED (MEC) OR FOR CUTTER WITH MANUAL FEED (MAN) SAME PRICES
- POUR FRAISES AVEC AVANCEMENT MECANIQUE (MEC) OU POUR FRAISES AVEC AVANCEMENT MANUEL (MAN) LES MÊMES PRIX
- GLEICHE PREISE FÜR FRÄSER MIT HAND (MAN)- UND AUTOMATISCHEN VORSCHUB (MEC)
- PARA FRESAS MEC (AVANCE MECÁNICO) O PARA FRESAS MAN (AVANCE MANUAL) LOS MISMOS PRECIOS
- PER FRESE IN HSS O HW STESSO PREZZO
- FOR CUTTERS IN HSS OR HW TIPPED SAME PRICES
- POUR FRAISES HSS BRASÉES OU HW BRASÉES LES MÊMES PRIX
- GLEICHE PREISE FÜR FRÄSER IN HSS UND HW
- PARA FRESAS HSS O MD (HW) LOS MISMOS PRECIOS
- PER FRESE Z=2 = -15% / PER FRESE Z=3 = -5% / PER ACCOPPIAMENTO +10%
- FOR CUTTERS WITH Z=2 = -15% / FOR CUTTERS Z=3 = -5% / TO COMBINE +10%
- POUR FRAISES Z=2 = -15% / POUR FRAISES Z=3 = -5% / POUR ACCOUPLEMENT +10%
- -15% FÜR FRÄSER MIT Z=2 / -5% FÜR FRÄSER MIT Z=3 / +10% FÜR PAARUNG
- PARA FRESAS Z=2 = -15% / PARA FRESAS Z=3 = -5% / PARA ACOPLAMIENTO +10%

FRESA SAGOMATA

PROFILED CUTTER ON REQUEST
 FRAISE PROFILÉE SUR DEMANDE
 PROFIL FRAESER
 FRESA PERFILADA

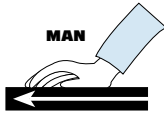

HW
HSS

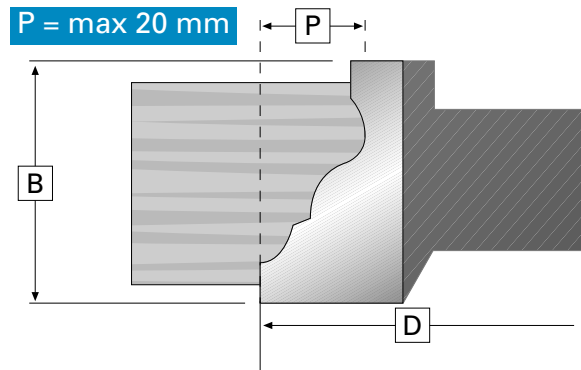

Costruita su disegno o campione legno. Con taglienti riportati in HSS o HW con sagoma profilo P=max 20mm
 Cutter on request HSS or HW tipped with profile depth P=max 20mm
 Fraise profilée sur demande brasée en HSS ou HW avec avancement P= max 20mm
 Fräseser nach Zeichnung oder Holzmuster mit Aufbauschneiden aus HSS oder HW und Profil P=max 20 mm
 Fresa construida a diseño o según muestra de madera soldada en HSS ou HW a perfil P=max 20mm

D.100 n. 7700 - 12000
D.120 n. 6400 - 9500
D.140 n. 5500 - 8000
D.160 n. 4800 - 7000
D.180 n. 4300 - 6300
D.200 n. 3900 - 5700

Z=4

Art.	D	B	Cod*	Art.	D	B	Cod*
002.120.Z410	120	10	44A	002.140.Z410	140	10	44I
002.120.Z420	120	20	45C	002.140.Z420	140	20	46C
002.120.Z430	120	30	46G	002.140.Z430	140	30	47H
002.120.Z440	120	40	48A	002.140.Z440	140	40	49B
002.120.Z450	120	50	49F	002.140.Z450	140	50	50G
002.120.Z460	120	60	50G	002.140.Z460	140	60	51H
002.120.Z470	120	70	51J	002.140.Z470	140	70	52H
002.120.Z480	120	80	53B	002.140.Z480	140	80	54C
002.120.Z490	120	90	54H	002.140.Z490	140	90	55G
002.120.4100	120	100	60A	002.140.4100	140	100	60G

002.160.Z410	160	10	45B	002.180.Z410	180	10	46C
002.160.Z420	160	20	47B	002.180.Z420	180	20	47I
002.160.Z430	160	30	48D	002.180.Z430	180	30	49E
002.160.Z440	160	40	50D	002.180.Z440	180	40	51A
002.160.Z450	160	50	51J	002.180.Z450	180	50	52H
002.160.Z460	160	60	53D	002.180.Z460	180	60	53H
002.160.Z470	160	70	54C	002.180.Z470	180	70	54J
002.160.Z480	160	80	55G	002.180.Z480	180	80	60C
002.160.Z490	160	90	60G	002.180.Z490	180	90	60G
002.160.4100	160	100	61D	002.180.4100	180	100	61I

002.200.Z410	200	10	47B
002.200.Z420	200	20	48G
002.200.Z430	200	30	50C
002.200.Z440	200	40	52C
002.200.Z450	200	50	53F
002.200.Z460	200	60	54J
002.200.Z470	200	70	60C
002.200.Z480	200	80	60J
002.200.Z490	200	90	61G
002.200.4100	200	100	62D

- PER FRESE CON AVANZAMENTO MECCANICO (MEC) O MANUALE (MAN) STESSO PREZZO
- FOR CUTTERS WITH MECHANICAL FEED (MEC) OR FOR CUTTER WITH MANUAL FEED (MAN) SAME PRICES
- POUR FRAISES AVEC AVANCEMENT MECANIQUE (MEC) OU POUR FRAISES AVEC AVANCEMENT MANUEL (MAN) LES MÊMES PRIX
- GLEICHE PREISE FÜR FRÄSER MIT HAND (MAN)-UND AUTOMATISCHEN VORSCHUB (MEC)
- PARA FRESAS MEC (AVANCE MECÁNICO) O PARA FRESAS MAN (AVANCE MANUAL) LOS MISMOS PRECIOS
- PER FRESE IN HSS O HW STESSO PREZZO
- FOR CUTTERS IN HSS OR HW TIPPED SAME PRICES
- POUR FRAISES HSS BRASÉES OU HW BRASÉES LES MÊMES PRIX
- GLEICHE PREISE FÜR FRÄSER IN HSS UND HW
- PARA FRESAS HSS O MD (HW) LOS MISMOS PRECIOS
- PER FRESE Z=2 = -15% / PER FRESE Z=3 = -5% / PER ACCOPPIAMENTO +10%
- FOR CUTTERS WITH Z=2 = -15% / FOR CUTTERS Z=3 = -5% / TO COMBINE +10%
- POUR FRAISES Z=2 = -15% / POUR FRAISES Z=3 = -5% / POUR ACCOUPLEMENT +10%
- -15% FÜR FRÄSER MIT Z=2 / -5% FÜR FRÄSER MIT Z=3 / +10% FÜR PAARUNG
- PARA FRESAS Z=2 = -15% / PARA FRESAS Z=3 = -5% / PARA ACOPLAMIENTO +10%

FRESA SAGOMATA

PROFILED CUTTER ON REQUEST
 FRAISE PROFILÉE SUR DEMANDE
 PROFIL FRAESER
 FRESA PERFILADA

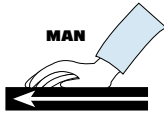

HW
HSS

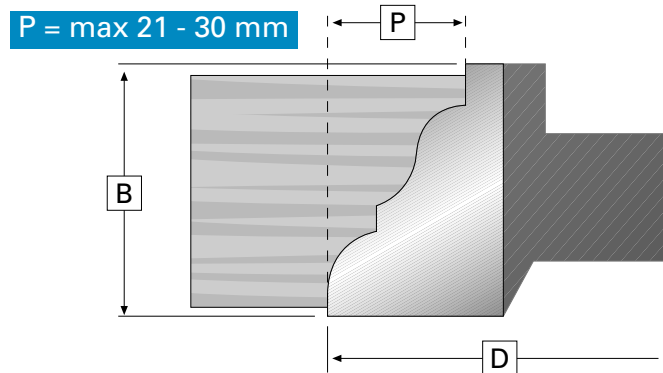

Costruita su disegno o campione legno. Con taglianti riportati in HSS o HW con sagoma profilo P=max 30mm
 Cutter on request HSS or HW tipped with profile depth P=max 30mm
 Fraise profilée sur demande brasée en HSS ou HW avec avancement P= max 30mm
 Fräser nach Zeichnung oder Holzmuster mit Aufbauschneiden aus HSS oder HW und Profil P=max 30 mm
 Fresa construida a diseño o según muestra de madera soldada en HSS ou HW a perfil P=max 30mm

D.140 n. 5500 - 8000
D.160 n. 4800 - 7000
D.180 n. 4300 - 6300
D.200 n. 3900 - 5700

Z=4

Art.	D	B	Cod*	Art.	D	B	Cod*
003.140.Z410	140	10	46F	003.160.Z410	160	10	47A
003.140.Z420	140	20	48C	003.160.Z420	160	20	49D
003.140.Z430	140	30	50A	003.160.Z430	160	30	50I
003.140.Z440	140	40	51H	003.160.Z440	160	40	53B
003.140.Z450	140	50	53F	003.160.Z450	160	50	55B
003.140.Z460	140	60	54I	003.160.Z460	160	60	60E
003.140.Z470	140	70	60B	003.160.Z470	160	70	60J
003.140.Z480	140	80	60J	003.160.Z480	160	80	61I
003.140.Z490	140	90	61I	003.160.Z490	160	90	62H
003.140.4100	140	100	62H	003.160.4100	160	100	63G
003.180.Z410	180	10	48C	003.200.Z410	200	10	49D
003.180.Z420	180	20	50B	003.200.Z420	200	20	51C
003.180.Z430	180	30	52A	003.200.Z430	200	30	53B
003.180.Z440	180	40	54A	003.200.Z440	200	40	55F
003.180.Z450	180	50	60A	003.200.Z450	200	50	60F
003.180.Z460	180	60	60G	003.200.Z460	200	60	61D
003.180.Z470	180	70	60G	003.200.Z470	200	70	62C
003.180.Z480	180	80	62C	003.200.Z480	200	80	63B
003.180.Z490	180	90	62H	003.200.Z490	200	90	63J
003.180.4100	180	100	64C	003.200.4100	200	100	64H

- PER FRESE CON AVANZAMENTO MECCANICO (MEC) O MANUALE (MAN) STESSO PREZZO
- FOR CUTTERS WITH MECHANICAL FEED (MEC) OR FOR CUTTER WITH MANUAL FEED (MAN) SAME PRICES
- POUR FRAISES AVEC AVANCEMENT MECANIQUE (MEC) OU POUR FRAISES AVEC AVANCEMENT MANUEL (MAN) LES MÊMES PRIX
- GLEICHE PREISE FÜR FRÄSER MIT HAND (MAN) - UND AUTOMATISCHEN VORSCHUB (MEC)
- PARA FRESAS MEC (AVANCE MECÁNICO) O PARA FRESAS MAN (AVANCE MANUAL) LOS MISMOS PRECIOS

- PER FRESE IN HSS O HW STESSO PREZZO
- FOR CUTTERS IN HSS OR HW TIPPED SAME PRICES
- POUR FRAISES HSS BRASÉES OU HW BRASÉES LES MÊMES PRIX
- GLEICHE PREISE FÜR FRÄSER IN HSS UND HW
- PARA FRESAS HSS O MD (HW) LOS MISMOS PRECIOS

- PER FRESE Z=2 = -15% / PER FRESE Z=3 = -5% / PER ACCOPPIAMENTO +10%
- FOR CUTTERS WITH Z=2 = -15% / FOR CUTTERS Z=3 = -5% / TO COMBINE +10%
- POUR FRAISES Z=2 = -15% / POUR FRAISES Z=3 = -5% / POUR ACCOUPLEMENT +10%
- -15% FÜR FRÄSER MIT Z=2 / -5% FÜR FRÄSER MIT Z=3 / +10% FÜR PAARUNG
- PARA FRESAS Z=2 = -15% / PARA FRESAS Z=3 = -5% / PARA ACOPLAMIENTO +10%

FRESA SAGOMATA

PROFILED CUTTER ON REQUEST
 FRAISE PROFILÉE SUR DEMANDE
 PROFIL FRAESER
 FRESA PERFILADA



HW
HSS

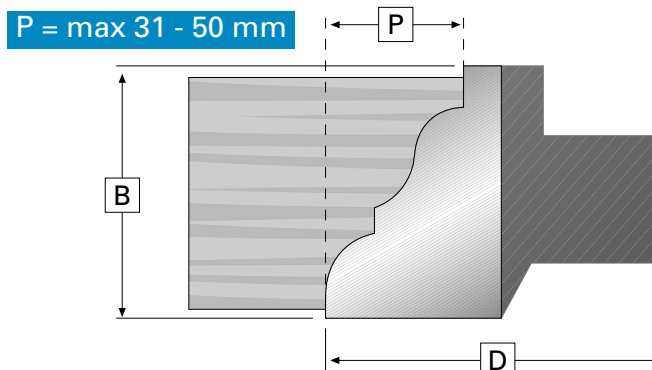

Costruita su disegno o campione legno. Con taglienti riportati in HSS o HW con sagoma profilo P=max 50mm
 Cutter on request HSS or HW tipped with profile depth P=max 50mm
 Fraise profilée sur demande brasée en HSS ou HW avec avancement P= max 50mm
 Fraeser nach Zeichnung oder Holzmuster mit Aufbauschneiden aus HSS oder HW und Profil P=max 50 mm
 Fresa construida a diseño o según muestra de madera soldada en HSS ou HW a perfil P=max 50mm

D.140 n. 5500 - 8000
D.160 n. 4800 - 7000
D.180 n. 4300 - 6300
D.200 n. 3900 - 5700

Z=4

Art.	D	B	Cod*	Art.	D	B	Cod*
03S.140.Z410	140	10	47I	03S.160.Z410	160	10	48D
03S.140.Z420	140	20	49I	03S.160.Z420	160	20	50J
03S.140.Z430	140	30	51H	03S.160.Z430	160	30	52G
03S.140.Z440	140	40	53H	03S.160.Z440	160	40	55D
03S.140.Z450	140	50	55H	03S.160.Z450	160	50	60H
03S.140.Z460	140	60	60G	03S.160.Z460	160	60	61H
03S.140.Z470	140	70	61D	03S.160.Z470	160	70	62D
03S.140.Z480	140	80	62D	03S.160.Z480	160	80	63D
03S.140.Z490	140	90	63D	03S.160.Z490	160	90	64D
03S.140.4100	140	100	64D	03S.160.4100	160	100	65C
03S.180.Z410	180	10	49I	03S.200.Z410	200	10	50J
03S.180.Z420	180	20	51J	03S.200.Z420	200	20	53B
03S.180.Z430	180	30	54A	03S.200.Z430	200	30	55C
03S.180.Z440	180	40	60B	03S.200.Z440	200	40	61A
03S.180.Z450	180	50	61D	03S.200.Z450	200	50	61J
03S.180.Z460	180	60	61J	03S.200.Z460	200	60	62H
03S.180.Z470	180	70	62H	03S.200.Z470	200	70	63I
03S.180.Z480	180	80	63H	03S.200.Z480	200	80	64I
03S.180.Z490	180	90	64D	03S.200.Z490	200	90	65G
03S.180.4100	180	100	66A	03S.200.4100	200	100	66G

- PER FRESE CON AVANZAMENTO MECCANICO (MEC) O MANUALE (MAN) STESSO PREZZO
- FOR CUTTERS WITH MECHANICAL FEED (MEC) OR FOR CUTTER WITH MANUAL FEED (MAN) SAME PRICES
- POUR FRAISES AVEC AVANCEMENT MECANIQUE (MEC) OU POUR FRAISES AVEC AVANCEMENT MANUEL (MAN) LES MÊMES PRIX
- GLEICHE PREISE FÜR FRÄSER MIT HAND (MAN) - UND AUTOMATISCHEN VORSCHUB (MEC)
- PARA FRESAS MEC (AVANCE MECÁNICO) O PARA FRESAS MAN (AVANCE MANUAL) LOS MISMOS PRECIOS

- PER FRESE IN HSS O HW STESSO PREZZO
- FOR CUTTERS IN HSS OR HW TIPPED SAME PRICES
- POUR FRAISES HSS BRASÉES OU HW BRASÉES LES MÊMES PRIX
- GLEICHE PREISE FÜR FRÄSER IN HSS UND HW
- PARA FRESAS HSS O MD (HW) LOS MISMOS PRECIOS

- PER FRESE Z=2 = -15% / PER FRESE Z=3 = -5% / PER ACCOPPIAMENTO +10%
- FOR CUTTERS WITH Z=2 = -15% / FOR CUTTERS Z=3 = -5% / TO COMBINE +10%
- POUR FRAISES Z=2 = -15% / POUR FRAISES Z=3 = -5% / POUR ACCOUPLEMENT +10%
- -15% FÜR FRÄSER MIT Z=2 / -5% FÜR FRÄSER MIT Z=3 / +10% FÜR PAARUNG
- PARA FRESAS Z=2 = -15% / PARA FRESAS Z=3 = -5% / PARA ACOPLAMIENTO +10%

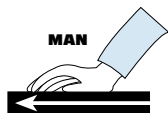

FRESA SAGOMATA. COSTRUITA SU DISEGNO O CAMPIONE LEGNO. CON TAGLIANTI RIPORTATI IN HSS O HW

CUTTER ON REQUEST HSS OR HW TIPPED
 FRAISE PROFILÉE SUR DEMANDE BRASÉE EN HSS OU HW
 FRÄSER NACH ZEICHNUNG ODER HOLZMUSTER MIT AUFBAUSCHNEIDEN AUS HSS ODER HW
 FRESA CONSTRUIDA A DISEÑO O SEGÚN MUESTRA DE MADERA SOLDADA EN HSS O HW

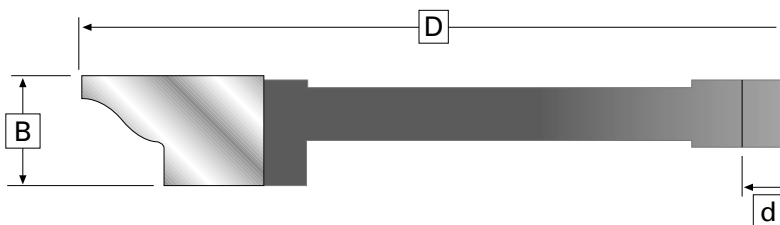

HW
HSS

D.250 n.3000-5000
 D.270 n.2900-4900



Art.	D	B	Z	Cod*
029.250.Z410	250	10	4	46F
029.250.Z412	250	12	4	46H
029.250.Z414	250	14	4	47A
029.250.Z416	250	16	4	47D
029.250.Z418	250	18	4	47G
029.250.Z420	250	20	4	48A
029.250.Z422	250	22	4	48D
029.250.Z425	250	25	4	48H
<hr/>				
029.270.Z410	270	10	4	47A
029.270.Z412	270	12	4	47C
029.270.Z414	270	14	4	47F
029.270.Z416	270	16	4	47I
029.270.Z418	270	18	4	48B
029.270.Z420	270	20	4	48F
029.270.Z422	270	22	4	48I
029.270.Z425	270	25	4	49C

- PER MISURE DIVERSE CHIEDERE OFFERTA
- FOR DIFFERENT MEASURES, ASK FOR AN OFFER
- POUR D'AUTRES MESURES, DEMANDER UNE OFFRE
- FÜR ANDERE MASSE, EIN ANGEBOT VERLANGEN
- PARA MEDIDAS DIFERENTES, SOLICITAR OFERTA

- PER FRESE CON AVANZAMENTO MECCANICO (MEC) O MANUALE (MAN) STESSO PREZZO
- FOR CUTTERS WITH MECHANICAL FEED (MEC) OR FOR CUTTER WITH MANUAL FEED (MAN) SAME PRICES
- POUR FRAISES AVEC AVANCEMENT MÉCANIQUE (MEC) OU POUR FRAISES AVEC AVANCEMENT MANUELLE (MAN) LES MÊMES PRIX
- FÜR FRÄSER MIT MECHANISCHER VORSCHUB (MEC) O FÜR FRÄSER MIT HANDVORSCHUB (MAN) DIE GLEICHEN PREISE
- PARA FRESAS MEC (AVANCE MECÁNICO) O PARA FRESAS MAN (AVANCE MANUAL) LOS MISMOS PRECIOS

- PER FRESE IN HSS O HW STESSO PREZZO
- FOR CUTTERS IN HSS OR HW TIPPED SAME PRICES
- POUR FRAISES HSS BRASÉES OÙ HW BRASÉES LES MÊMES PRIX
- FÜR FRÄSER IN HSS O FÜR FRÄSER IN HW DIE GLEICHEN PREISE
- PARA FRESAS HSS O MD (HW) LOS MISMOS PRECIOS

- PER FRESE Z=2 = 15% DI SCONTO SULLA TABELLA Z=4 / PER FRESE Z=3 = 5% DI SCONTO SULLA TABELLA Z=4
- FOR CUTTERS WITH Z=2 = 15% DISCOUNT ON PRICE-LIST Z=4 / FOR CUTTERS Z=3 = 5% DISCOUNT ON PRICE-LIST Z=4
- POUR FRAISES Z=2 = -15% REMISE SUR LISTE DE PRIX Z=4 / POUR FRAISES Z=3 = -5% REMISE SUR LISTE DE PRIX Z=4
- FÜR FRÄSER MIT Z=2 = 15% DISKONT AUF PREIS-LISTE Z=4 / FÜR FRÄSER MIT Z=3 = 5% DISKONT AUF PREIS-LISTE Z=4
- PARA FRESAS DE 2 CORTES (Z=2) = 15% DESCUENTO SOBRE LAS TABLAS Z=4 / PARA FRESAS DE 3 CORTES (Z=3) = 5% DESCUENTO SOBRE LAS TABLAS Z=4

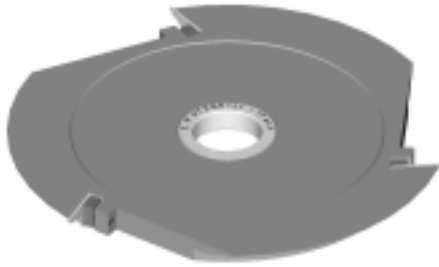

TESTA SAGOMATA.COSTRUITA SU DISEGNO O CAMPIONE LEGNO CON COLTELLI SAGOMATI

CUTTERHEAD ON REQUEST, SUPPLIED WITH PROFILED KNIVES
 PORTE-OUTIL SUR DEMANDE, FOURNIE AVEC PLAQUETTES PROFILÉES
 MESSERKOPF MIT PROFILPLATTEN IN SONDERFERTIGUNG
 CABEZALE CONSTRUIDA A DISEÑO O SEGÚN MUESTRA DE MADERA CON CUCHILLAS PERFILADAS

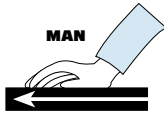

D.250 n.3000-5000
D.270 n.2900-4900
D.290 n.2700-4600

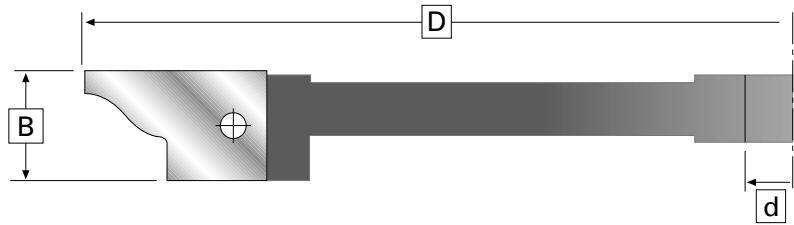

Art.	D	B	Z	Cod*
138.250.Z320	250	20	3	48F
138.250.Z330	250	30	3	50A
138.270.Z320	270	20	3	49B
138.270.Z330	270	30	3	50G
138.290.Z320	290	20	3	49G
138.290.Z330	290	30	3	51B

- PER TESTE CON AVANZAMENTO MECCANICO (MEC) O MANUALE (MAN) STESSO PREZZO / PER TESTE Z=2 = -10% / PER TESTE Z=4 = +20% / COMPLETO DI COLTELLI SAGOMATI. PER COLTELLI DI RICAMBIO VEDERE ART.710 O 720
- FOR CUTTERHEADS WITH MECHANICAL FEED (MEC) OR FOR CUTTERHEADS WITH MANUAL FEED (MAN) SAME PRICES / FOR CUTTERHEADS WITH Z=2 = -10% / FOR CUTTERS Z=4 = +20% / SUPPLIED WITH PROFILED KNIVES. SPARE PROFILED KNIVES SEE ART.710 OR 720
- POUR P.O. AVEC AVANCEMENT MÉCANIQUE (MEC) OU POUR P.O. AVEC AVANCEMENT MANUEL (MAN) LES MÊMES PRIX / POUR P.O. Z=2 = -10% / POUR P.O. Z=4 = +20% / FOURNI AVEC PLAQUETTES PROFILÉES. POUR PLAQUETTES PROFILÉES DE RECHANGE VOIR ART.710 OU 720
- FÜR MESSERKÖPFT MIT MECHANISCHER VORSCHUB (MEC) ODER FÜR MESSERKÖPFT MIT HANDVORSCHUB (MAN) DIE GLEICHEN PREISE / FÜR MESSERKÖPFT MIT Z=2 = -10% / FÜR MESSERKÖPFT MIT Z=4 = +20% / ARTIKEL WIRD MIT PROFILMESSERN AUSGELIEFERT. FÜR PROFILMESSERN ALS ERSATZTEIL SIEHE ARTIKEL 710 ODER 720.
- PARA CABEZALES MEC (AVANCE MECÁNICO) O PARA CABEZALES MAN (AVANCE MANUAL) LOS MISMOS PRECIOS / PARA CABEZALES DE Z=2 = -10% / PARA CABEZALES DE Z=4 = +20% / ARTICULO ABASTECIDO CON CUCHILLAS PERFILADOS PARA CUCHILLAS PERFILADOS DE REPUESTO VÉASE LOS ARTICULOS 710 O 720

ART. 4

FRESA MULTIPROFILI
MULTI-PROFILES CUTTER
FRAISE MULTI-PROFIL
MULTIPROFILFRÄSER
FRESA PARA PERFILES MULTIPLES

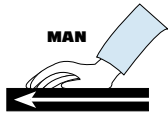
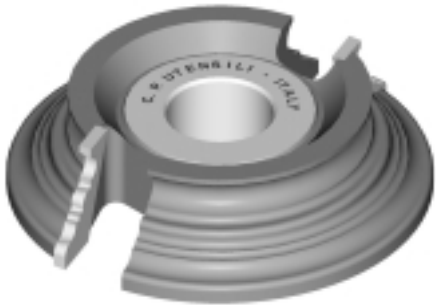

HW

D.140 n.5500-8000
D.160 n.4800-7000

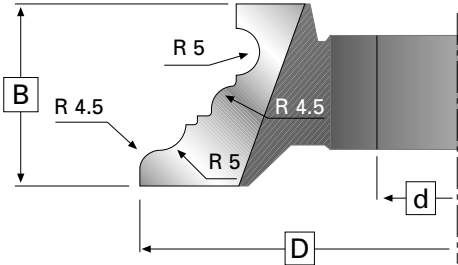

Art.	D	B	Z	d	Cod*
004.140.0000	140	40	2	30-35	45F
004.160.0000	160	40	2	40-50	45J

ART. 5

FRESA MULTIPROFILI

MULTI-PROFILES CUTTER
FRAISE MULTI-PROFIL
MULTIPROFILFRÄSER
FRESA PARA PERFILES MÚLTIPLES

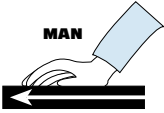
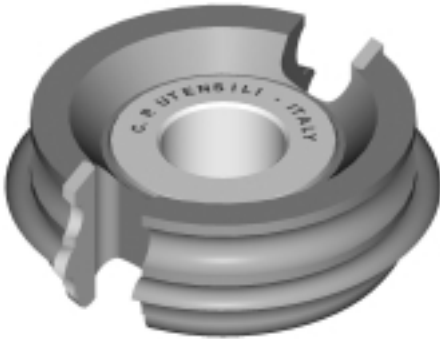

HW

D.120 n.6500-9500
D.140 n.5500-8000

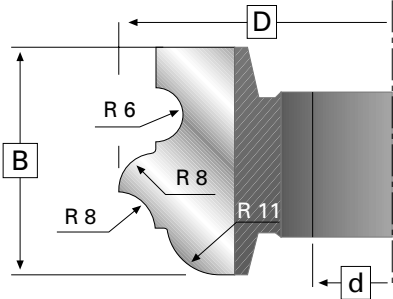

Art.	D	B	Z	d	Cod*
005.120.0000	120	50	2	30-35	45C
005.140.0000	140	50	2	40-50	45F

FRESA PER QUARTI DI TONDO

CUTTER FOR QUARTER ROUND
 FRAISE POUR QUART DE ROND
 VIERTELSTABFRÄSER
 FRESA PARA CUARTOS DE RETONDO

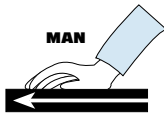
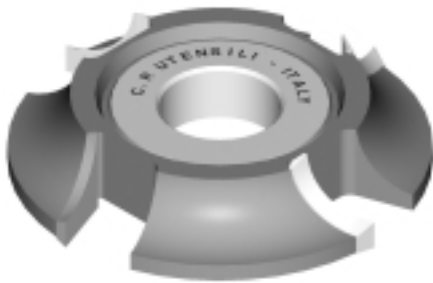

HW

D.140 n.5500-8000
 D.150 n.5000-7500
 D.160 n.4800-7000
 D.170 n.4500-6700
 D.180 n.4300-6300
 D.200 n.3900-5700

A

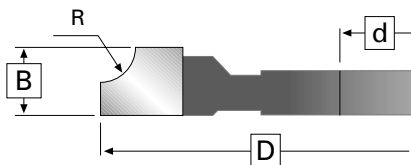

Art.	D	R	B	Z	d	Cod*
006.A05.0000	140	5	13	4	30-35-40-50	41G
006.A07.0000	140	7,5	15	4	30-35-40-50	42C
006.A10.0000	140	10	18	4	30-35-40-50	42I
006.A12.0000	140	12,5	20	4	30-35-40-50	43D
006.A15.0000	140	15	23	4	30-35-40-50	43J
006.A20.0000	140	20	28	4	30-35-40-50	44H
006.A25.0000	140	25	33	4	30-35-40	45G
006.A25.0F50	150	25	33	4	50	45J
006.A30.0000	160	30	38	4	30-35-40-50	47F
006.A35.0000	160	35	43	4	30-35-40	49E
006.A35.0F50	170	35	43	4	50	49G
006.A40.0000	180	40	48	4	30-35-40-50	51F
006.A45.0000	200	45	53	4	30-35-40-50	62F
006.A50.0000	200	50	58	4	30-35-40-50	63E

B

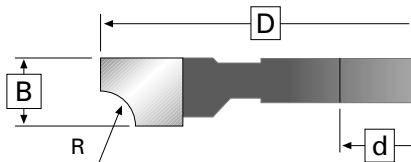

Art.	D	R	B	Z	d	Cod*
006.B05.0000	140	5	13	4	30-35-40-50	41G
006.B07.0000	140	7,5	15	4	30-35-40-50	42C
006.B10.0000	140	10	18	4	30-35-40-50	42I
006.B12.0000	140	12,5	20	4	30-35-40-50	43D
006.B15.0000	140	15	23	4	30-35-40-50	43J
006.B20.0000	140	20	28	4	30-35-40-50	44H
006.B25.0000	140	25	33	4	30-35-40	45G
006.B25.0F50	150	25	33	4	50	45J
006.B30.0000	160	30	38	4	30-35-40-50	47F
006.B35.0000	160	35	43	4	30-35-40	49E
006.B35.0F50	170	35	43	4	50	49G
006.B40.0000	180	40	48	4	30-35-40-50	51F
006.B45.0000	200	45	53	4	30-35-40-50	62F
006.B50.0000	200	50	58	4	30-35-40-50	63E

- PER MISURE DIVERSE CHIEDERE OFFERTA
- FOR DIFFERENT MEASURES, ASK FOR AN OFFER
- POUR D'AUTRES MESURES, DEMANDER UNE OFFRE
- FÜR ANDERE ABMESSUNGEN BITTE EIN ANGEHOT EINHOLEN
- PARA MEDIDAS DIFERENTES, SOLICITAR OFERTA

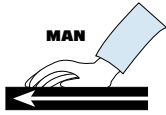

HW

D.140 n.5500-8000

ART. 7

FRESA PER QUARTI DI TONDO

CUTTER FOR QUARTER ROUND
FRAISE CONGÉE
VIERTELSTABFRÄSER
FRESA PARA CUARTOS DE RETONDO

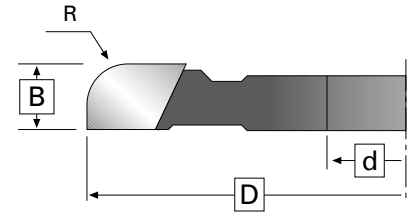

Art.	D	R	B	Z	d	Cod*
007.R10.0000	140	10	15	4	30-35-40-50	42E
007.R12.0000	140	12,5	17,5	4	30-35-40-50	43A
007.R15.0000	140	15	20	4	30-35-40-50	43G
007.R20.0000	140	20	25	4	30-35-40-50	44B

- PER MISURE DIVERSE CHIEDERE OFFERTA
- FOR DIFFERENT MEASURES, ASK FOR AN OFFER
- POUR D'AUTRES MESURES, DEMANDER UNE OFFRE
- FÜR ANDERE ABMESSUNGEN BITTE EIN ANGEBOT EINHOLEN
- PARA MEDIDAS DIFERENTES, SOLICITAR OFERTA

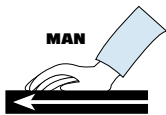

HW

D.140 n.5500-8000

ART. 8

FRESA PER MEZZI TONDI

CONVEX RADIUS CUTTER
FRAISE POUR CONGÉS
FRÄSER FÜR KEHLUNGEN
FRESA CON RADIO CONVEXO

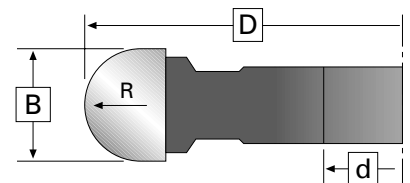

Art.	D	R	B	Z	d	Cod*
008.R04.0000	140	4	8	4	30-35-40-50	41E
008.R05.0000	140	5	10	4	30-35-40-50	41G
008.R06.0000	140	6	12	4	30-35-40-50	41J
008.R75.0000	140	7,5	15	4	30-35-40-50	42C
008.R10.0000	140	10	20	4	30-35-40-50	42H
008.R12.0000	140	12,5	25	4	30-35-40-50	43F
008.R15.0000	140	15	30	4	30-35-40-50	44G

- PER MISURE DIVERSE CHIEDERE OFFERTA
- FOR DIFFERENT MEASURES, ASK FOR AN OFFER
- POUR D'AUTRES MESURES, DEMANDER UNE OFFRE
- FÜR ANDERE ABMESSUNGEN BITTE EIN ANGEBOT EINHOLEN
- PARA MEDIDAS DIFERENTES, SOLICITAR OFERTA

FRESA PER MEZZI TONDI

CUTTER FOR HALF ROUND
 FRAISE POUR DEMI-ROND
 H A L B S T A B F R Ä S E R
 FRESA PARA MEDIO RETONDO

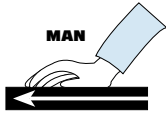
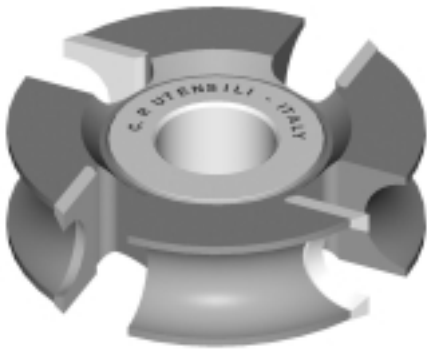

HW

D.140 n.5500-8000

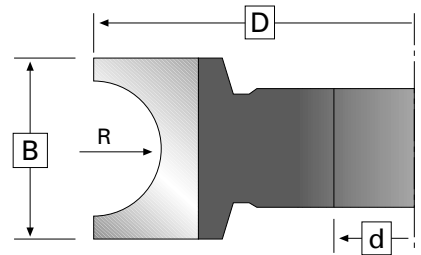

Art.	D	R	B	Z	d	Cod*
009.R05.0000	140	5	20	4	30-35-40-50	43I
009.R55.0000	140	5,5	20	4	30-35-40-50	43I
009.R06.0000	140	6	20	4	30-35-40-50	43I
009.R07.0000	140	7,5	25	4	30-35-40-50	44A
009.R10.0000	140	10	30	4	30-35-40-50	44E
009.R12.0000	140	12,5	35	4	30-35-40-50	45A
009.R15.0000	140	15	40	4	30-35-40-50	45H

- PER MISURE DIVERSE CHIEDERE OFFERTA
- FOR DIFFERENT MEASURES, ASK FOR AN OFFER
- POUR D'AUTRES MESURES, DEMANDER UNE OFFRE
- FÜR ANDERE ABMESSUNGEN BITTE EIN ANGEHOT EINHOLEN
- PARA MEDIDAS DIFERENTES, SOLICITAR OFERTA

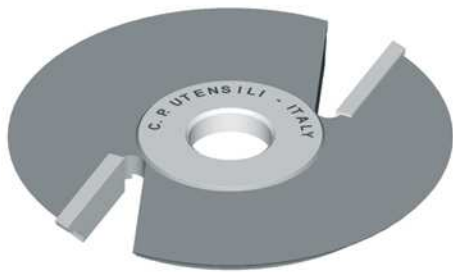

HW

D.160 n.4800-7100
D.180 n.4300-6300

ART. 18/1

FRESA PIATTABANDA

RAISED PANEL CUTTER
FRAISE POUR PLATE-BANDES
ABPLATT-FRÄSER
FRESA PARA PLAFONES

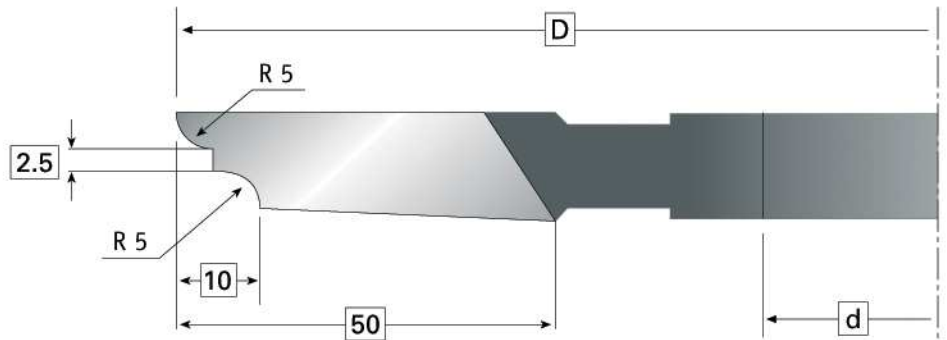

Art.	D	B	Z	d
018.160.1F00	160	16	2	30-35
018.180.1F00	180	16	2	40-50

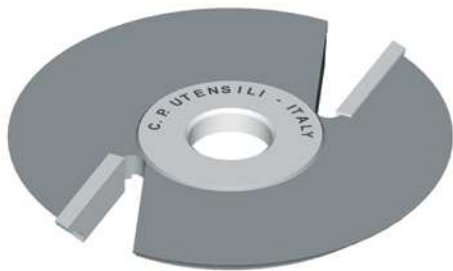

HW

D.160 n.4800-7100
D.180 n.4300-6300

ART. 18/2

FRESA PIATTABANDA

RAISED PANEL CUTTER
FRAISE POUR PLATE-BANDES
ABPLATT-FRÄSER
FRESA PARA PLAFONES

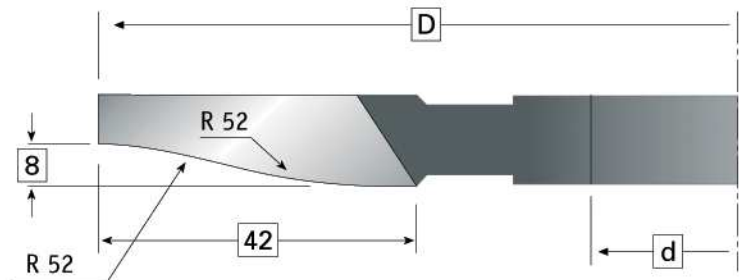

Art.	D	B	Z	d
018.160.2F00	160	20	2	30-35
018.180.2F00	180	20	2	40-50

ART. 60

GRUPPO PER GIUNZIONI

ADJUSTABLE GLUE JOINT CUTTER
FRAISE À BOUVETER EXTENSIBLE
VERSTELLBARER VERLEIMFRÄSER
FRESA EXTENSIBLE PARA JUNTAS ENCOLADAS

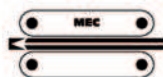

HW

n.max 8000

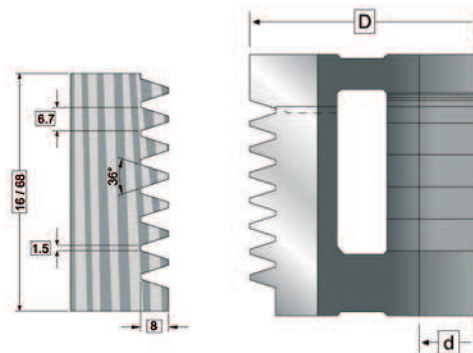

Art.	D	B	Z	d
060.140.0000	140	15-75	3+3	30-35-40-50

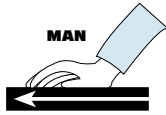

HW

n.5500-8000

ART. 61

FRESA PER GIUNZIONI
GLUE JOINT CUTTER
FRAISE À BOUVETER
VERLEIMFRÄSER
FRESA PARA JUNTAS ENCOLADAS

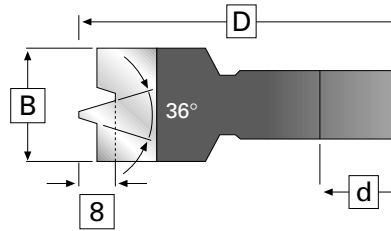

A

Art.	D	B	Z	d	Cod*
061.A00.0000	140	25	4	30-35-40-50	45E

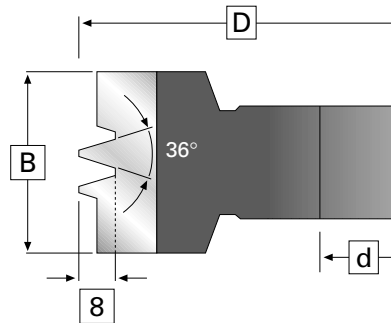

B

Art.	D	B	Z	d	Cod*
061.B00.0000	140	40	4	30-35-40-50	47F

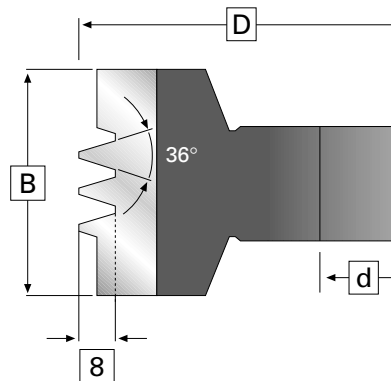
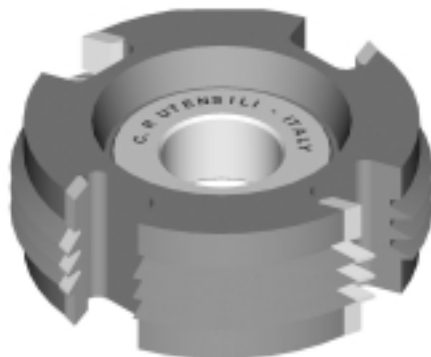

C

Art.	D	B	Z	d	Cod*
061.C00.0000	140	50	4	30-35-40-50	48H

ART. 62

FRESA PER GIUNZIONI

GLUE JOINT CUTTER
FRAISE À BOUVETER
VERLEIMFRÄSER
FRESA PARA JUNTAS ENCOLADAS

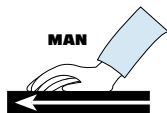
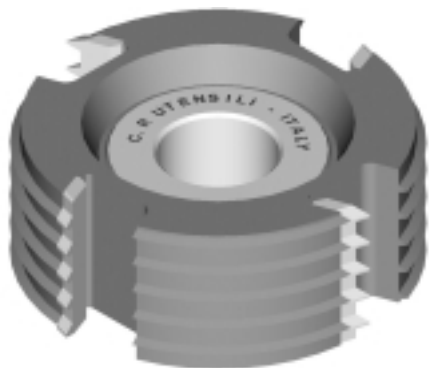

HW

n.5500-8000

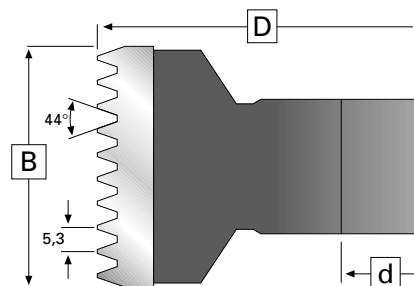

Art.	D	B	Z	d	Cod*
062.140.0000	140	53	4	30-35-40-50	47J